





* All images in this datasheet are for illustrative purposes only.

Outdoor LED GSCE Series

Ceiling LED Display for Virtual Production

 Easy Installation and Maintenance

 Front or Rear Serviceability

 High Brightness

 Power UI/UX with Megapixel® VR HELIOS® LED Processing Platform

GSCE

Pixel Pitch	3.91 mm
Brightness	Up to 5,000 nits
Weight per Cabinet	27.3 lbs. / 12.4 kg
Service Access	Front or Rear (Select One Only)
IP Rating Front / Rear	IP30 / IP30



Fast Installation

Installers can easily set up and dismantle LED screens thanks to magnets on the top and bottom. Positioning pins, handles, and fast locks further aid in tool-free installation.



Easy Maintenance

The GSCE series applied a simple Lock Fixing method which requires no additional tools, making it easier to replace LED modules or power/data units. It saves cost and time for maintenance.

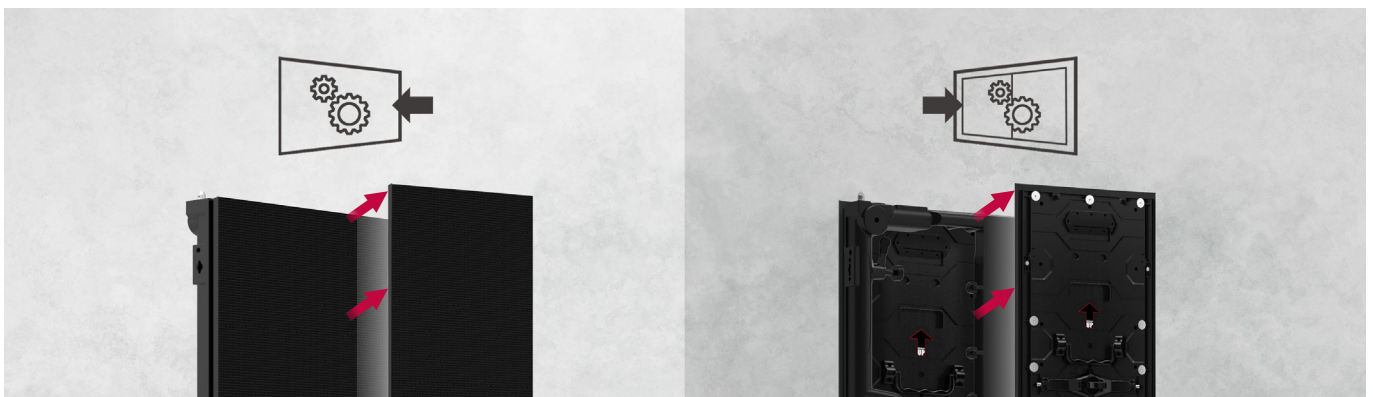

Front or Rear Serviceability

The product offers either front access or rear access, allowing customers to choose installation options according to their environment and minimizes limitations in installation and maintenance.

Approx. 400 SQM



Approx. 50 ~ 100 SQM

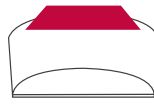

Approx. 20 ~ 50 SQM

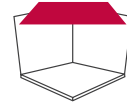

High Brightness

The ceiling LED up to 5,000 nits enables GSCE series to be used for alternative lightings in XR and virtual production.

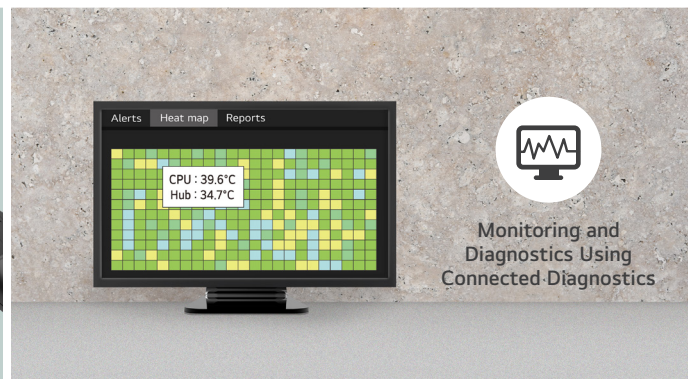
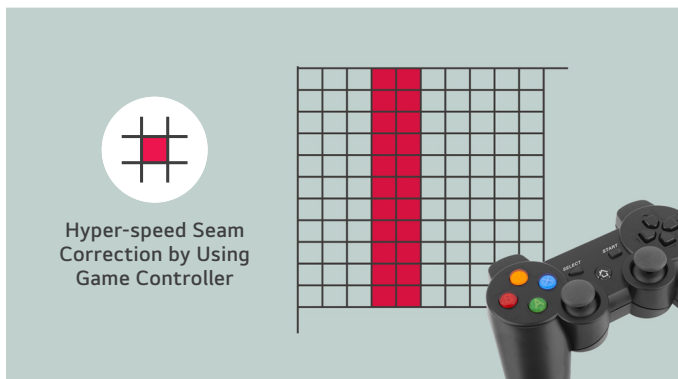
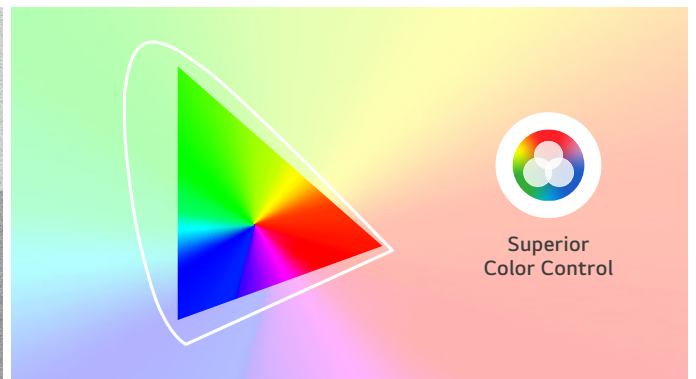
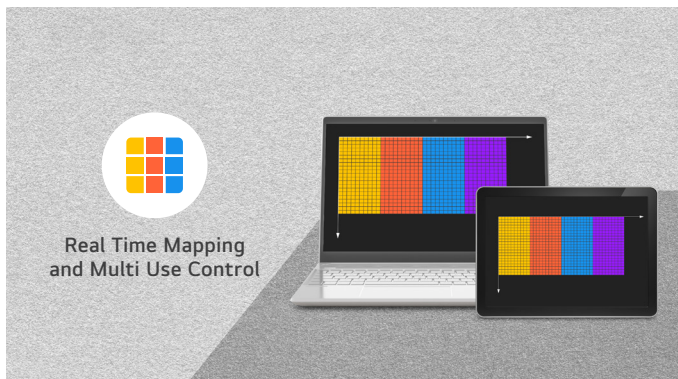

Powerful UI/UX with Megapixel VR HELIOS LED Processing Platform

Thanks to the compatibility between GSCE and the Megapixel VR HELIOS LED* processing platform, you can now utilize the powerful UX and UI functionalities offered by HELIOS. HELIOS processing platform includes Real-Time Mapping and Multi-User Control, Superior Color Control, Hyper-Speed Seam Correction using a game controller, and Monitoring and Diagnostics through connected diagnostics.

* Please note that Megapixel VR HELIOS LED processing platform needs to be purchased separately, and depending on the actual usage environment, there may be limitations in the implementation of certain features offered by HELIOS. A game controller needs to be purchased separately.

SPECIFICATIONS

GSCE039-GN

Pitch Name		P3.91
Physical Parameters	Pixel Configuration	Single SMD
	Pixel Pitch (mm)	3.91
	Module Resolution (W x H)	64 x 128
	Module Dimensions (W x H, in. / mm)	9.8 x 19.6 in. / 250 x 500 mm
	Weight per Module (lbs. / kg)	3.1 lbs. / 1.4 kg
	No. of Modules per Cabinet (W x H)	2 x 2
	Cabinet Resolution (W x H)	128 x 256
	Cabinet Dimensions (W x H x D, in. / mm)	19.6 x 39.4 x 2.6 in. 500 x 1,000 x 66.05 mm
	Cabinet Surface Area (ft ² / m ²)	5.4 ft ² / 0.5m ²
	Weight per Cabinet (lbs. / kg)	27.3 / 12.4
	Weight per Square Meter (kg/m ²)	24.9
	Physical Pixel Density (pixels/m ²)	65,536
	Flatness of Cabinet (mm)	±0.3
	Cabinet material	Die-casting Magnesium
	Service Access	Front or Rear (Select One Only)
Optical Specifications	Max. Brightness (After Calibration, nits)	5,000
	Color Temperature (K)	2,000-11,000
	Visual Viewing Angle (H x V)	160° x 155°
	Brightness Uniformity	0.97
	Color Uniformity	±0.003 Cx, Cy
	Contrast Ratio	6,000 : 1
	Processing Depth (bit)	16 (PQ, HLG)
Electrical Specifications	Max Power Consumption per Cabinet (W)	300
	Avg. Power Consumption per Cabinet (W)	100
	Max Power Consumption (W/m ²)	600
	Max Heat Dissipation per Cabinet (BTU/h)	1,024
	Avg. Heat Dissipation per Cabinet (BTU/h)	341
	Max Heat Dissipation (BTU/h/m ²)	2,047
	Power Supply (Vac)	100 to 240
	Frame Rate (Hz)	50 / 60
Refresh Rate (Hz)	3,840	
Operation Specifications	Operating Temperature (°F / °C)	-22 to 113 / -30 to +45
	Operating Humidity	10-99% RH
	IP Rating Front / Rear	IP30 / IP30
Warranty & Other	Warranty	3 Year Limited
	Regulatory	CE, FCC, ETL
	Environmental	RoHS
	Controller	Megapixel VR HELIOS LED Processing Platform
	90 Degree Corner Cut	No

Megapixel VR HELIOS LED Processing Platform (Controller)

Cabinet		GSCE
Max Output Range	Loading Capacity	8,192 x 4,320 @ 60 Hz
	Output Resolution	35.3 Million Pixels
Input	HDMI 2.0, HDCP 2.2, DP 1.4 (HBR3), SDI (4 x 12G-SDI), OPS (ST2110)	
Output	Optic (To LED Screen (8 x 10G))	
Control	LAN	Yes
	GenLock	Yes (In)
Video Processing	Brightness Adjustment, Chroma Adjustment, Improved Grayscale at Low Brightness, Scaling, HDR (PQ, HLG, Custom), EDID Custom	
Application	SuperSign CMS (Cross-platform Web Interface), webOS API, Configuration SW (Cross-platform Web Interface)	
Mechanical	Size (W x H x D, in. / mm)	18.9 x 1.7 x 15.5 in. 481.5 x 44.2 x 393 mm
	Weight (lbs. / kg)	12.6 lbs. / 5.7kg

* Specifications are subject to change without notice. Please make sure to check the product manual for details about product usage.